

231 S. PLEASANT AVE, ONTARIO, CA 91761

LARGE FULLY SECURED YARD

**HIGH IMAGE INDUSTRIAL BUILDING
26,360 SF FOR LEASE**

PLEASE CONTACT:



KEN JONES, SIOR
Senior Vice President/Principal
kjones@lee-assoc.com
(909)-373-2726
DRE # 01703262

DAVID NGUYEN
Senior Vice President/Principal
dnguyen@lee-assoc.com
909.373.2725
DRE # 01880998

MICHAEL CHAVEZ
Senior Vice President/Principal
mchavez@lee-assoc.com
909.373.2900
DRE # 00929693

BEN PALITZ
Senior Associate
bpalitz@lee-assoc.com
(909)-373-2910
DRE # 02093182

COLE MCFETERS
Associate
cmcfeters@lee-assoc.com
(909)-373-2733
DRE #02203508

3535 Inland Empire Boulevard | Ontario, California 91764 | 909-989-7771 | lee-associates.com | Corporate DRE #: 00976995

All information furnished regarding property for sale, rental or financing is from sources deemed reliable, but no warranty or representation is made to the accuracy thereof and same is submitted to errors, omissions, change of price, rental or other conditions prior to sale, lease or financing or withdrawal without notice. No liability of any kind is to be imposed on the broker herein.

PROPERTY OVERVIEW

KEY HIGHLIGHTS



± 26,360 SF
BUILDING SIZE



± 4,000 SF
HIGH IMAGE OFFICE (TWO-STORY)



32'
MINIMUM CLEARANCE



4
DOCK HIGH LOADING POSITION



ESFR
SPRINKLER SYSTEM



LARGE
FULLY FENCED & SECURED YARD

PROPERTY HIGHLIGHTS

- CLASS 'A' HIGH IMAGE FACILITY
- 1 - GROUND LEVEL LOADING DOOR
- LED LIGHTING INTERIOR & EXTERIOR
- 800 AMPS EXPANDABLE TO 1,600 AMPS (VERIFY)
- IMMEDIATE ACCESS TO I-10, I-15, CA-60 FREEWAYS
- 29 DESIGNATED PARKING STALLS
- ZONED M3- GENERAL INDUSTRIAL (VERIFY)
- 213.5' SECURED CONCRETE TRUCK COURT



SITE PLAN

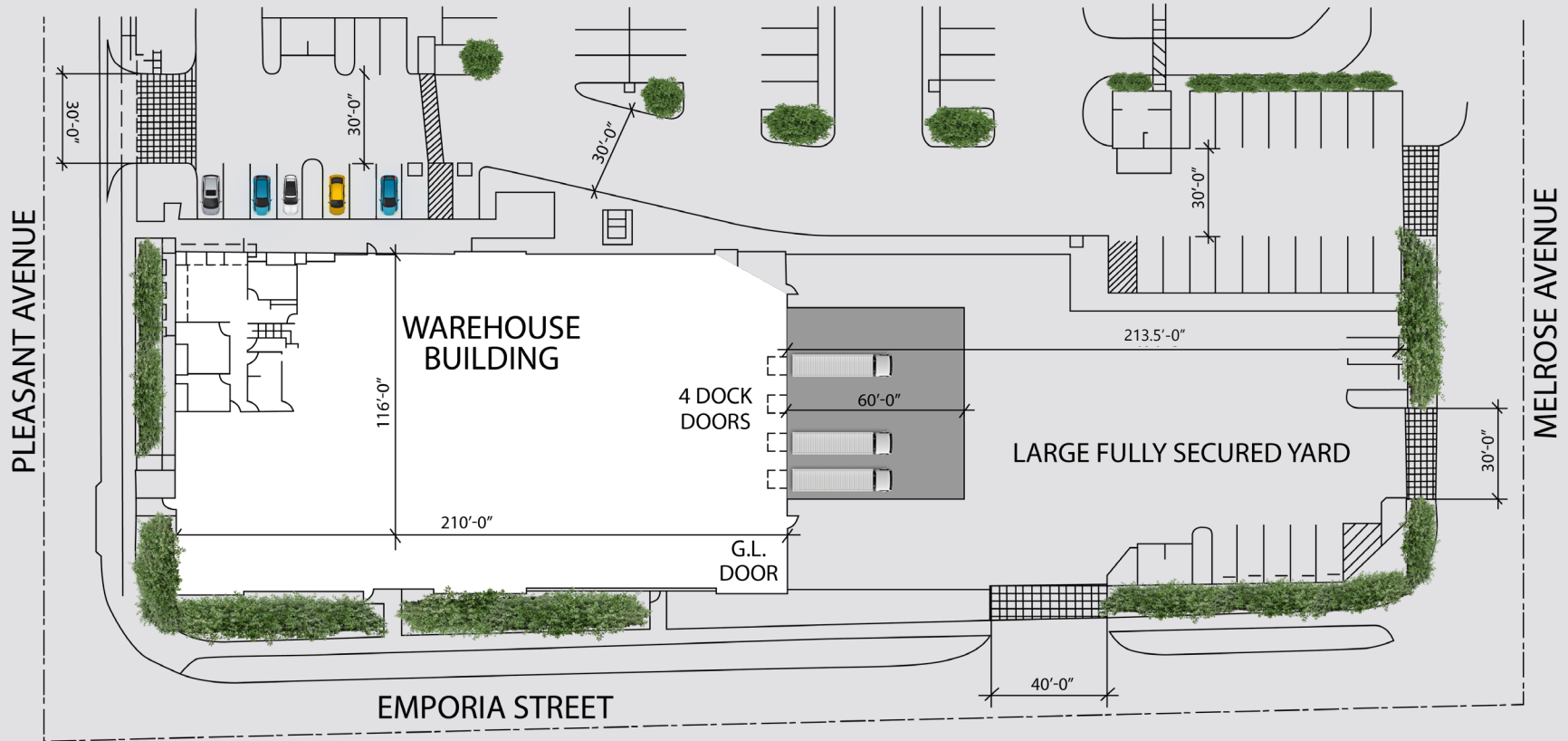

LOCATION MAP

231 S PLEASANT AVE.

