

# HIGH IMAGE FREESTANDING BUILDING

1047 E. ACACIA STREET | ONTARIO | CALIFORNIA



**AVAILABLE FOR LEASE**  
**±8,158 SQUARE FEET**

 [JONESINDUSTRIALTEAM.COM](http://JONESINDUSTRIALTEAM.COM)

FOR MORE INFORMATION, PLEASE CONTACT:

**JONES**  
INDUSTRIAL TEAM

**KEN JONES, SIOR**  
Senior Vice President/Principal  
kjones@lee-assoc.com  
909.373.2726  
DRE # 01703262

**BEN PALITZ**  
Senior Vice President/Principal  
bpalitz@lee-assoc.com  
909.373.2910  
DRE # 02093182

**COLE MCFETTERS**  
Associate  
cmcfetters@lee-assoc.com  
909.373.2733  
DRE #02203508

3535 Inland Empire Boulevard | Ontario | California 91764 | 909-989-7771 | [lee-associates.com](http://lee-associates.com) | Corporate DRE #: 00976995

 **LEE & ASSOCIATES**  
COMMERCIAL REAL ESTATE SERVICES

# PROPERTY OVERVIEW

## PROPERTY HIGHLIGHTS

- RECENTLY RENOVATED
- LED LIGHTING IN THE OFFICE
- T8 MOTION SENSOR LIGHTING IN THE WAREHOUSE
- ALL CONCRETE DRIVEWAY AND YARD AREA
- FIRE SPRINKLERED
- IMMEDIATE ACCESS TO THE I-10, AND CA-60 FREEWAYS

## KEY HIGHLIGHTS



**±8,158 SF**  
BUILDING SIZE



**±1,424 SF**  
OF HIGH IMAGE OFFICE SPACE



**400 AMPS**  
277/480 VOLTS (VERIFY)



**16'**  
MINIMUM CLEARANCE



**TWO (2)**  
GROUND LEVEL LOADING DOORS  
(12' X 14')



**LARGE, FULLY FENCED**  
AND SECURED YARD



# SITE PLAN

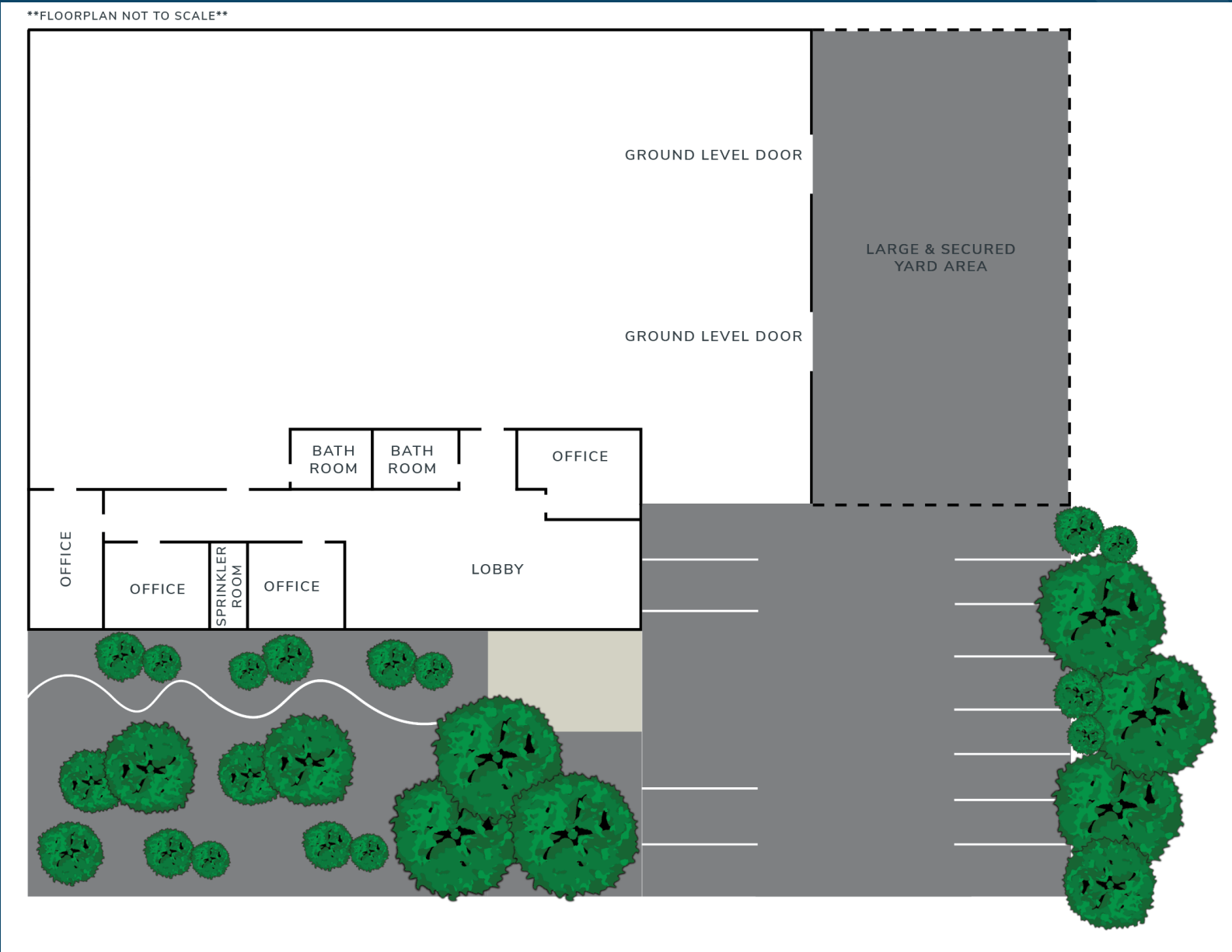



# LOCATION MAP

